



Rev. 07/2021

## **LOADING PUMP**

Water treatment liquids.

# LOADING PUMP

Water treatment liquids.

The device is used for loading liquid products into closed circuits that are not under pressure or are partially under pressure.

### RECOMMENDATIONS FOR USE:

- Remove pressure from the closed circuit
- Load the product to be inserted into the circuit into the loading pump tank.
- Connect the brass end of the nozzle to a point in the system.
- Pressurise the device through the pumping unit connected to the upper handle and press the nozzle lever fully down; the system will fully charge all the product present. It may be necessary to re-pressurise the tank via the pump.



### ASSEMBLY INSTRUCTIONS

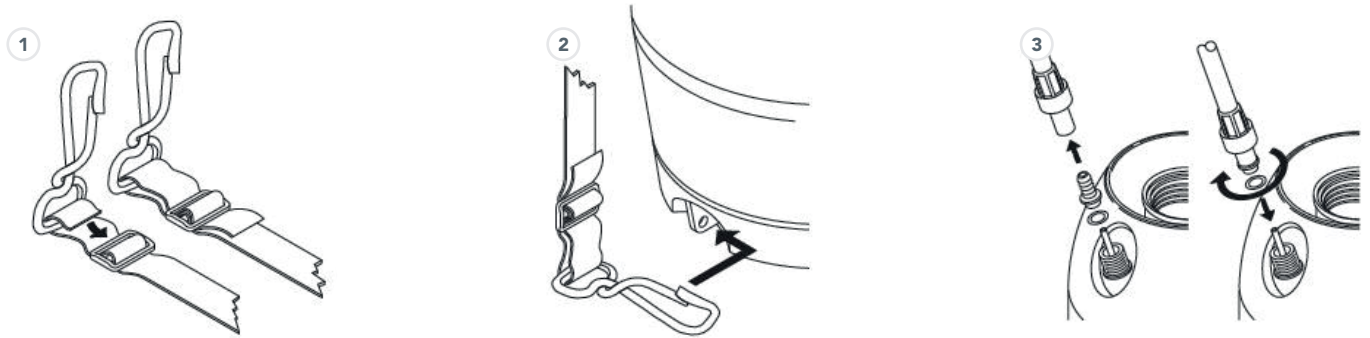

Follow the assembly of the belt:

- 1 2 Attach the belt to the pump by adjusting the desired length, so that the pump can be brought to the most comfortable position without undue fatigue.

- 3 Follow the assembly of the pipe.

**ATTENTION: Improper use or tampering releases the manufacturer from any liability.**

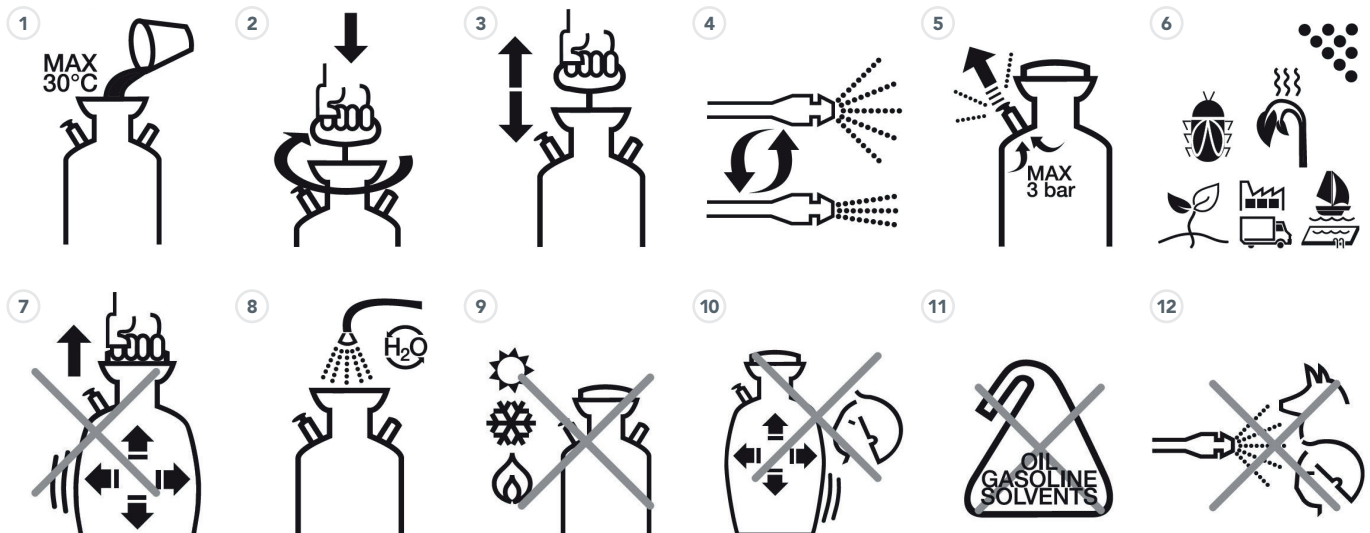

## COMPONENTS DESCRIPTION



- 1 **Pump:** EPDM gaskets
- 2 **Graduated safety valve**
- 3 **Adjustable carrying strap**
- 4 **Tank:** Total capacity 3 l, max. pressure 3 bar
- 5 **System fitting:** fitted with G 1/8", G 1/4", G 3/8" male interchangeable couplings
- 6 **Injection nozzle with valve**



*RBM spa reserves the right to improve and change the products described and relevant technical data at any moment and without prior notice. The information and images contained in this document are intended for information purposes only, are not binding and in any case do not exempt the user from strictly following the regulations in force and good practice standards.*